

LUMAIRE

by **LeddeX**

LED LIGHT SHEETS: DESIGN – MANUFACTURE – LIGHTING PROJECTS

Lumaire Wayfinding

MAGNETIC SHEETS FOR SIGNAGE





ONE CLICK BACKLIT LIGHTING DESIGN

Lumaire Wayfinding



- Frame Thickness is just 15 mm (single or double-sided)
- Brightness up to 11000 lx on the surface depending on size
- Single or double sided, curved
- Low power consumption
- Wide application possibilities, from interior design to signage
- Opal acrylic 2 mm
- PVC film

Lumaire Wayfinding is an opal acrylic light diffusing sheet with PVC print. The LED light panel is specifically suitable for directional sign lighting.

SUPPORT 24/7, PROTECTION & WARRANTY



VARIATIONS

1.-2. Wayfinding wall fixation

Affix your Lumaire Wayfinding to the wall anywhere you need with one simple click.







3. Wayfinding one-sided

Lumaire Wayfinding with reflector emits light from the front.

4.-6. Wayfinding portable stand

Two-sided Lumaire Opal emits light from both the front and rear of the surface. Portable stand is a mobile installation that facilitates the use of the LED panel.

Technical specifications

| | | | |
|---|---|--|---|
| MAIN MATERIAL Clear acrylic (PMMA) | LUMINOUS EFFICIENCY up to 160 lm/W | POWER SUPPLY DC 12V / 24V / CC Adaptor | COLOUR TEMPERATURE  3000 K  4000 K  5000 K  6500 K  CCT (Special order)  RGB (Special order) |
| FRAME THICKNESS 15 mm (S.S. and D.S.) | IP RATING IP 20 | WORKING VOLTAGE DC 12V / DC 24V / DC CC <small>(RGB only 12 V)</small> | |
| MAXIMUM SIZE FROM ONE SHEET 2800 x 1250 mm | LIFETIME > 50,000 hours | INPUT VOLTAGE AC 100 ~ 240V 50/60Hz | |
| MAXIMUM (PROFILE) LENGTHS 5000 mm | OPERATING TEMPERATURE -30°C ~ + 40°C | LED TAPE POWER one-sided 15 W/m two-sided 30 W/m | |

PACKAGE INCLUDES:

Power supply (Mean well GST series power supply)

Fixing & mounting

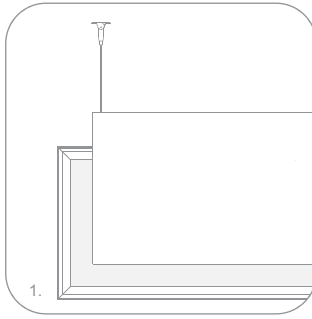

1. Two-point cable fixation.
max 2000 mm, max 20 kg

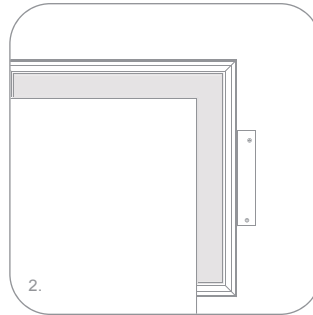

2. Wall fixation

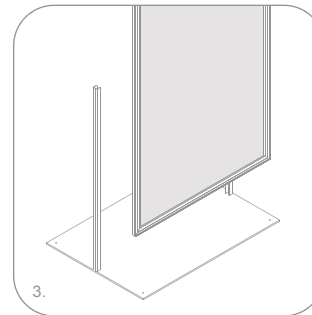

3. Portable stand.

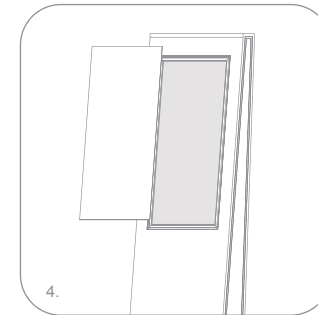

4. Portable stand.

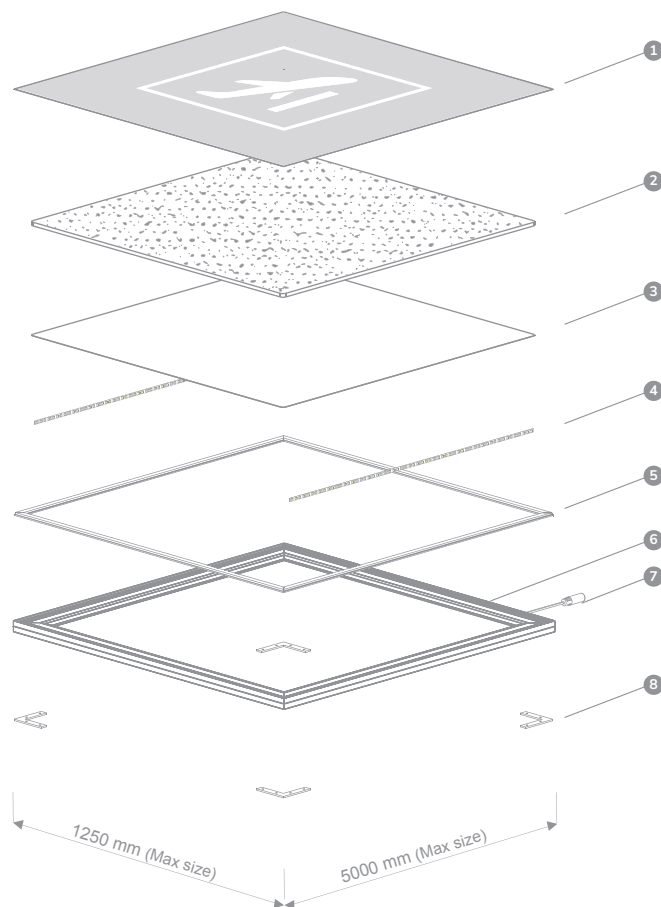

PRODUCT STRUCTURE

Technical & usage

- | | |
|-------------------------------|--------------------|
| 1. PVC film on opal | 5. Magnet |
| 2. Lumaire light-guided plate | 6. Aluminium frame |
| 3. Reflector | 7. DC cable |
| 4. LED tape | 8. Brackets |

Print

The final step of the light panel is to choose, design and manufacture the desirable print you want to light up. Every standard PVC film on milky and rigid print works perfectly with Lumaire light panels.

Lumaire light-guide plate

The most important part of the light panel is the acrylic sheet designed for even light distribution on the entire surface of the product, leaving no room for hot spots or darker areas you want to light up.

Reflector

A flexible material designed for supreme light reflection and color enhancement, making the most of LED lighting and acrylic sheet.

LED strips

High power LED strips with integrated Intelligent Control (IC) system for ultimate reliability and maximum lighting effect.

Magnetic frame

To deal with the heat LED bar is generating, high cooling efficiency aluminum frames are used to cool down the LED bar and to ensure optimal operating temperatures and long lifespan of the product.

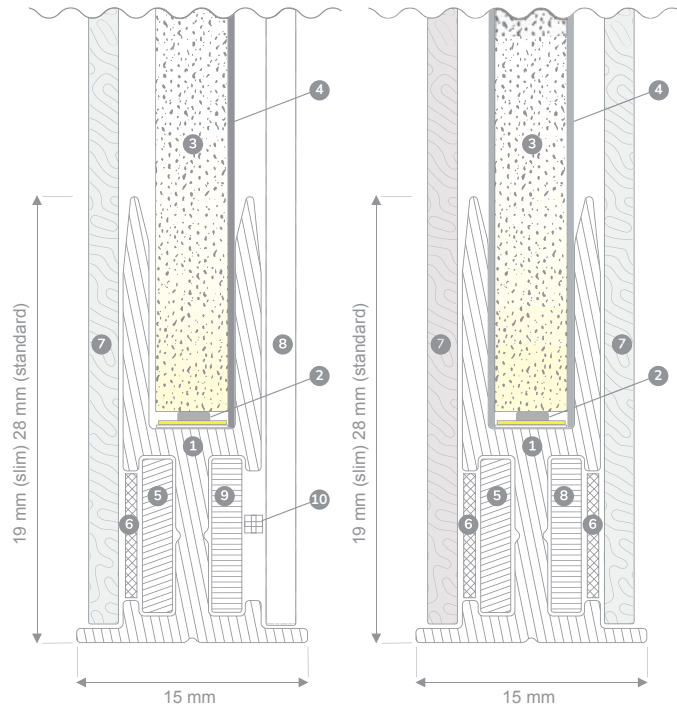

Magnetic Led panel - SINGLE

Magnetic Led panel - DOUBLE

LUMAIRE PROFILES

Lumaire Wayfinding frame components

MAGNETIC LED PANEL - SINGLE

1. Aluminium frame
2. LED strips
3. Lumaire light-guided plate
4. Reflector lumaire
5. Magnet
6. Metal strip
7. Protective acrylic sheet
8. Aluminum back plate (optional)
9. Brackets L shape
10. Screw

MAGNETIC LED PANEL - DOUBLE

1. Aluminium frame
2. LED strips
3. Lumaire light-guided plate
4. Diffuser
5. Magnet
6. Metal strip
7. Protective acrylic sheet
8. Brackets

Lighting Projects

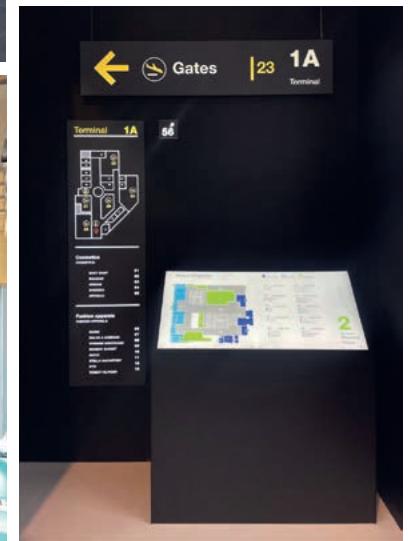
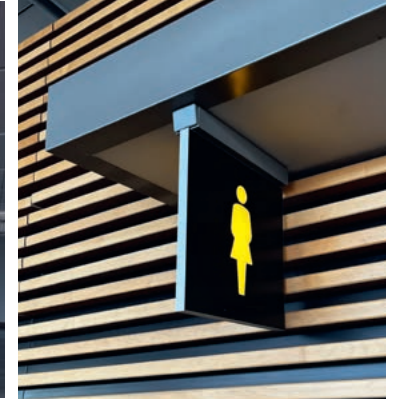

Example

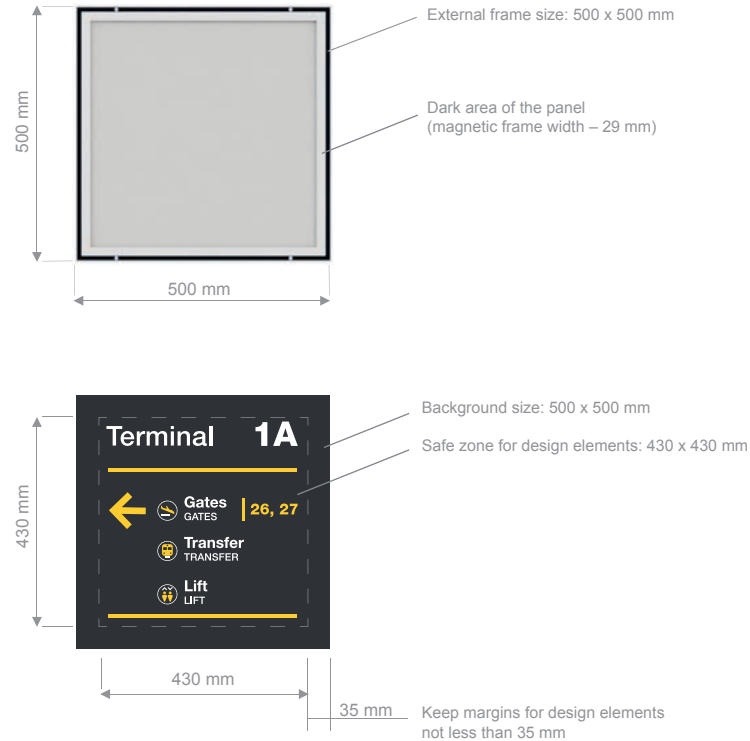

PRINT ON BACKLIT

Wayfinding: file preparation

Wayfinding top visual layer production consists of: color printing on milky sheets and plotter cutting of self-adhesive PVC.

DESIGN ELEMENTS AREA

Please note that the standard magnetic frame is 29 mm wide. This means that the 30 mm wide margins are unlit areas. The safe zone for lighted design elements should be 35 mm smaller from each border.

FILE PREPARATION

All elements for cut plotting should be in vector file format. For detailed file preparation, please get in touch with your printing house.

CALCULATION EXAMPLE

| EXTERNAL FRAME (BACKGROUND) SIZE | DESIGN ELEMENTS AREA |
|-------------------------------------|-------------------------|
| 500 x 700 | 430 x 630 |
| 1000 x 700 | 930 x 630 |
| 594 x 840 <i>A1</i> | 524 x 770 |
| 2800 x 1250 <i>Max size</i> | 2730 x 1180 |

We are here to provide you with reliable services.
Because we are the ones

— who inspire through light

CONTACT:

Phone

Phone: +370 5 212 7244
Mobile: +370 645 83037

Adress

Elektrinės str. 8, LT-03150
Vilnius, Lithuania

Email

Mail 01: info@lumaire.eu
Mail 02: guoda@leddex.eu

Designed &
manufactured
in Lithuania

