

ULTRA THIN-PERFECT BASIC DESIGN

Lumaire Basic



3 YEARS WARRANTY

APPLICATIONS

- POS Display
- Signage
- Advertising
- Trade fairs
- Retail
- Interior design
- Hotels

FEATURES

- Thickness is just 5mm (8 mm with heat sink)
- Brightness up to 11000lx on the surface depending on size
- Single or double sided, curved and custom shape options
- Low power consumption
- Wide application possibilities, from interior design to signage
- OPAL front cover 2mm, optional

TECHNICAL SPECIFICATIONS

MAIN MATERIAL
Clear acrylic (PMMA)

LUMINOUS EFFICIENCY
up to 160lm/W

MAXIMUM SIZE
2450 x 1250 mm

POWER SUPPLY
DC 12V / 24V / CC Adaptor

LIGHT TRANSMISSION
93%

COLOUR TEMPERATURE
3000K 4000K 5000K 6500K

LIFETIME
> 50,000 hours

WORKING VOLTAGE
DC 12V / DC 24V / DC CC

THICKNESS
5mm acrylic, 8mm including heat sink

IP RATING
IP 20

OPERATING TEMPERATURE
-30°C ~ + 40°C

INPUT VOLTAGE
AC 100 ~ 240V 50/60Hz



TECHNICAL DRAWING

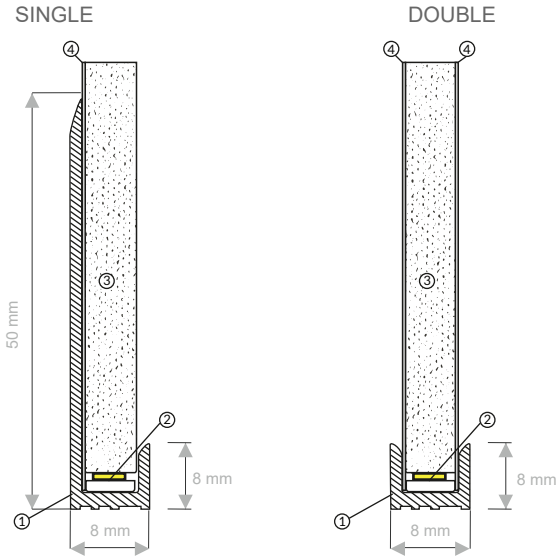

- SINGLE
1. Frame basic
 2. LED bar
 3. Acrylic sheet
 4. Reflector

- DOUBLE
1. Frame basic
 2. LED bar
 3. Acrylic sheet
 4. Diffuser

PACKAGE INCLUDES

Power supply (Mean well GST series power supply)

MOUNTING INFORMATION

| SIZE (Y), mm | → | ← | CENTER | → | ← |
|--------------|--------|--------|--------|--------|--------|
| 200-700 | 80 mm | 80 mm | | | |
| 700-1000 | 150 mm | 150 mm | | | |
| 1000-1500 | 150 mm | 150 mm | • | | |
| 1500-2000 | 150 mm | 150 mm | | 700 mm | 700 mm |
| 2000-2450 | 150 mm | 150 mm | • | 700 mm | 700 mm |

Holes will be drilled on both long sides (panel size (Y))
 → Pre drilled hole position from the left edge ← Pre drilled hole position from the right edge

